

## Page Linking in Springboard

When you want to link pages, you have to first create the page you want to link. For example, let's create a page for another book to read. Suppose you want to read the book, "The Wheels on the Bus". First, we will create a page to read the book. (Note: To follow these instructions, you need to be in one of the 8 location user areas: SB Unity 8-word or SB Unity 8-phrase)

### To create a page:

1. Go into the toolbox and select CREATE PAGE.

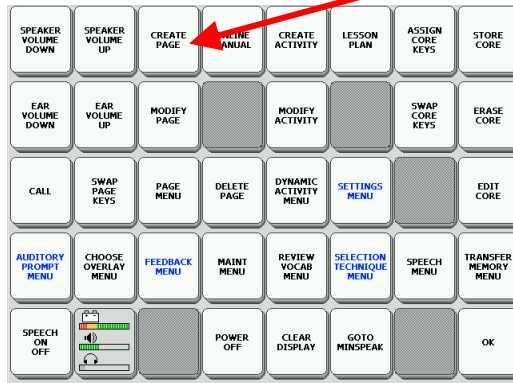

2. Spell the name of the page (i.e. 8WHEELS) [NOTE: I usually name a page beginning with the number keys on that page]. Then select OK.
3. Now select the number of keys (or locations) you want on that page.

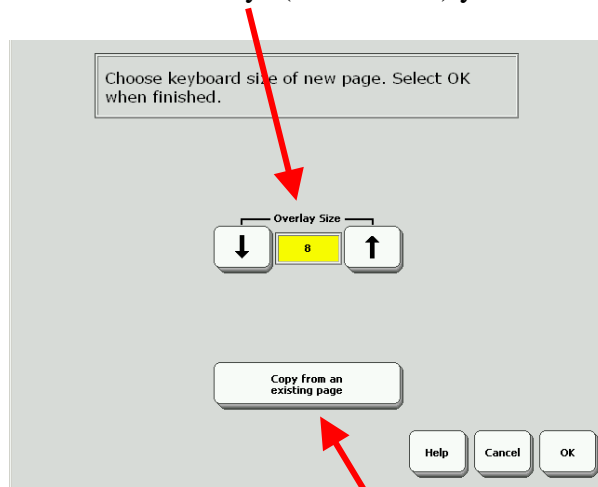

4. If you want to, you can select "copy from an existing page to use the template that is already created. That template has a link to go back to the core vocabulary.

5. If you choose to copy the template, select 8TEMPLATE.

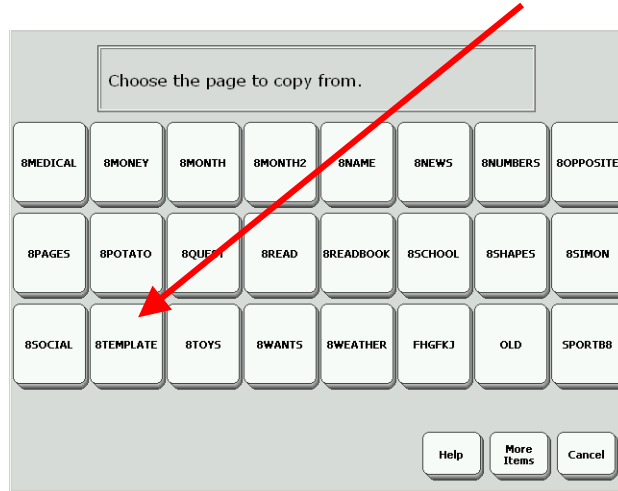

- 6. You should now have a page that is blank except for the BACK Key.
- 7. Select the first key you want to define (or “work on”).
- 8. You can now, spell the text, change the icon, change the label, and record the speech.

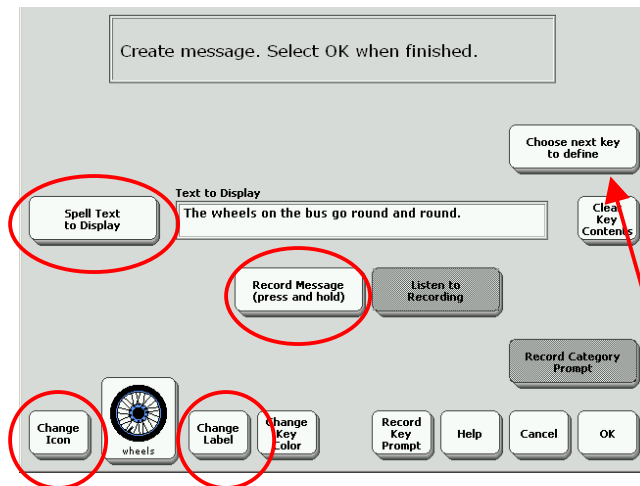

- 9. When you have finished with that key, select CHOOSE NEXT KEY TO DEFINE. Continue modifying the next key in the same way.
- 10. When you have finished all the keys you want, select OK.

To Link the page:

Now that you have created the page, you are ready to link it. We are going to link it to the page with the other books (8READ). To do this, we need to begin with the page 8EAD.

1. Go into the TOOLBOX and select MODIFY PAGE.



2. Choose 8READ

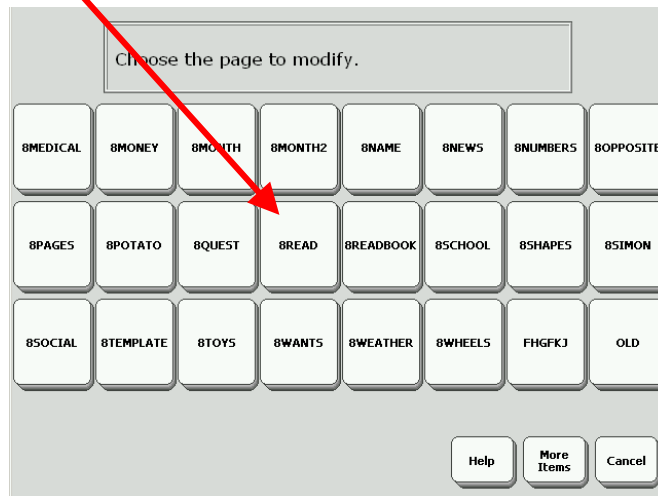

3. Select the location where you want to put this new book.
4. Choose SPELL TEXT TO DISPLAY.

5. Instead of spelling a message, we are going to insert a tool. Select INSERT TOOL.

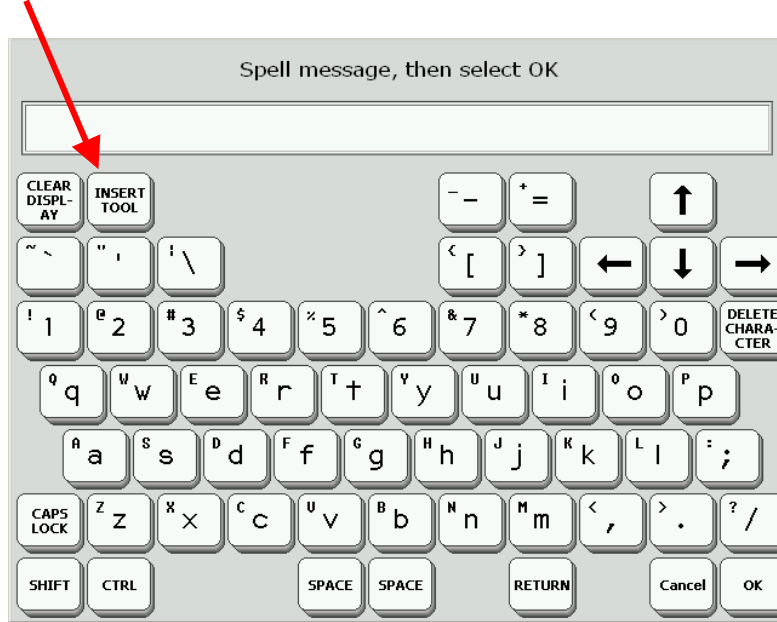

6. The TOOL we use for page linking is called SET PAGE. Use MORE ITEMS until you find SET PAGE.

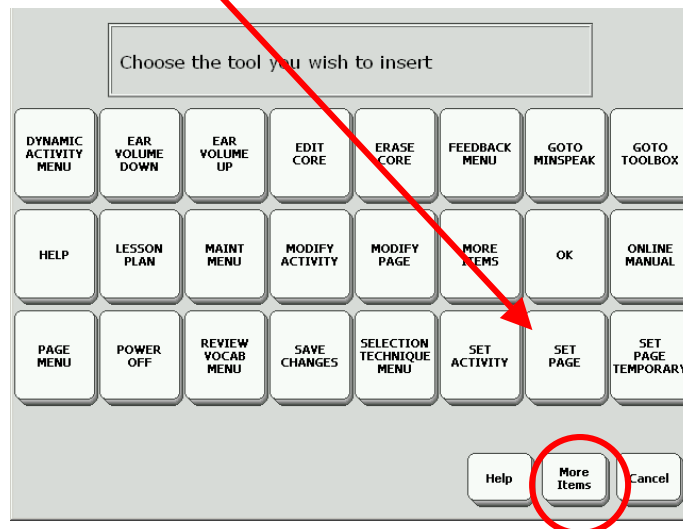

- You now see a list of all your pages. Since we want to link to 8WHEELS, select 8WHEELS. Your display should now look like this.

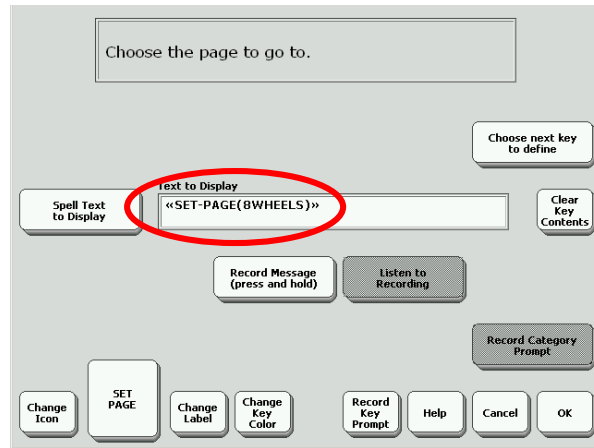

- You can now change the icon and the label. You can also add text and record a message, but it's not necessary.
- Select OK twice. Your display should now look something like this.

